

# Clemas & Co Ltd

Industrial Cleaning Equipment  
Sales - Hire - Service

## I - VAC PARTS MANUAL



**Clemas & Co.** Unit 5 Ashchurch Business Centre, Alexandra Way, Tewkesbury,  
Gloucestershire, GL20 8NB.

**Tel:** 01684 850777 **Fax:** 01684 850707

**Email:** [info@clemas.co.uk](mailto:info@clemas.co.uk) **Web:** [www.clemas.co.uk](http://www.clemas.co.uk)

# EXPLODED VIEWS

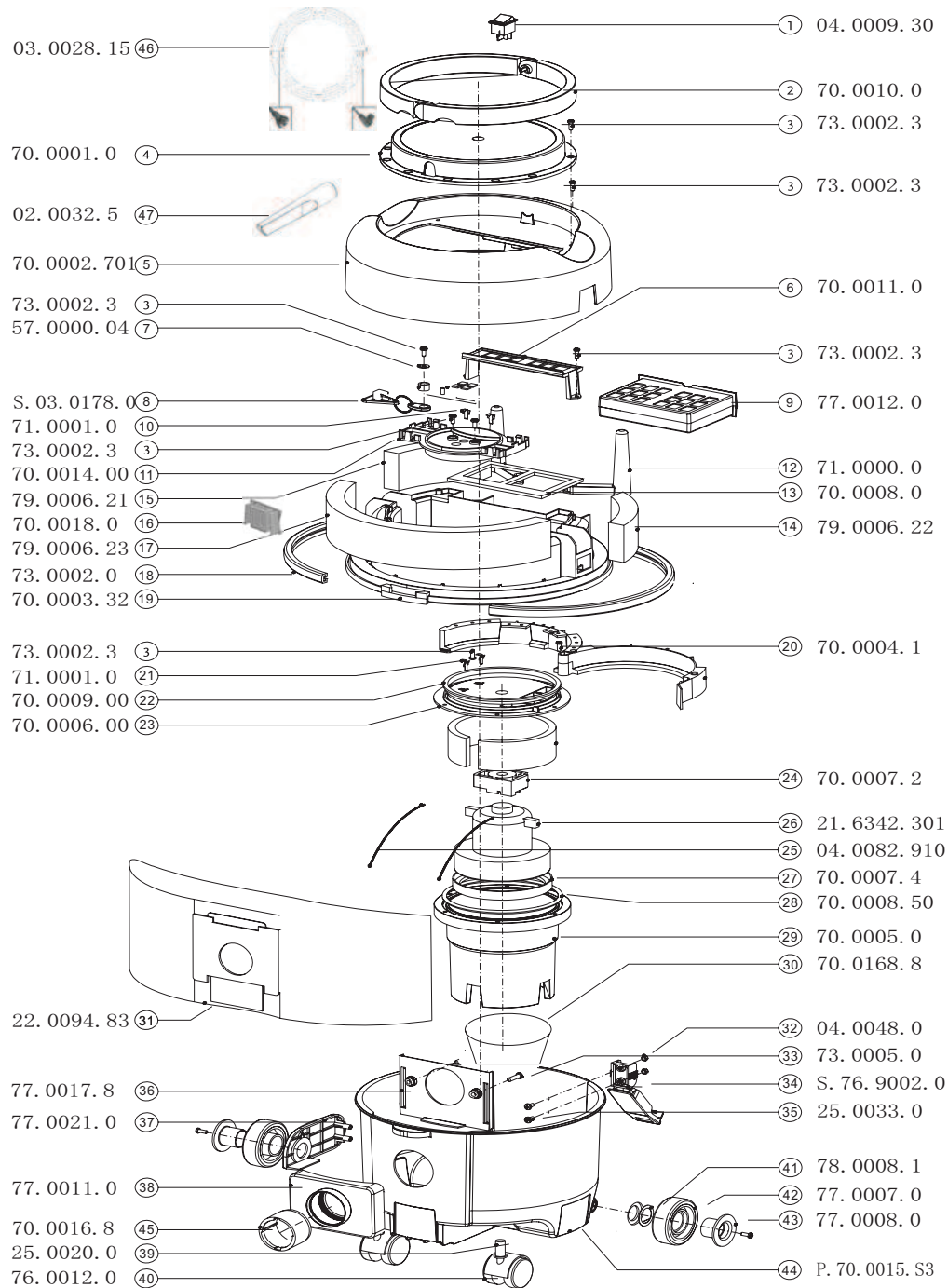

## EXPLODED VIEWS' ITEMS

NO.	ART CODE	DESCRIPTION	REF.	QTY.
1	04.0009.30	SWITCH 4P GREEN	66	1
2	70.0010.0	HANDLEGRIP BLACK C6	401	2
3	73.0002.3	SCREW 5x16	404	14
4	70.0001.0	DISPLAYCOVER BLACK C6	402	1
5	70.0002.701	COVER C6 BLUE	405	1
6	70.0011.0	FILTERFIX BRACKET C6 MAL17	420	1
7	57.0000.04	WASHER PLAIN M5	441	3
8	S.03.0178.0	CABLE RESTRAIN	S196	1
9	77.0012.0	CASSETTE FILTER C06/9 BLACK	413	1
10	71.0001.0	CONTACT FOR PLATE C06 N/R	407	2
11	70.0014.00	PCB FIXPLATE C6 MAL 27	415	1
12	71.0000.0	CABLE CLAMP BLACK	419	2
13	70.0008.0	FILTER RUBBER	417	1
14	79.0006.22	FOAM SIDE FORM 6(B)	409	1
15	79.0006.21	FOAM SIDE FORM 6(A)	418	1
16	70.0018.0	FRAME FRAGRANCE CASSETTE BLACK		1
17	79.0006.23	FOAM SIDE FORM	416	1
18	73.0002.32	PVC BUMPER C9/6 GREY	422	1
19	70.0003.32	COVERPLATE GREY C6	408	1
20	70.0004.1	MOTOR FIXING RING C06 MAL7	412	1
21	71.0001.0	CONTACTPLATE	407	2
22	70.0009.00	MOTOR RUBBER	439	1
23	70.0006.00	MOTOR COVER NEUTRAL 15%GF	410	1
24	70.0007.2	MOTOR SUSPEND RUBBER	414	1
25	04.0082.910	WIRE BL 1MM2 200MM PL/PL4.8 INSULATION CSA	447	2
26	21.6342.302	MOTOR D1 850W230V VPD AMETEK	394	1
27	70.0007.4	BOTTOM RUBBER C6 TK/AMETEK MOT	421	1
28	70.0008.50	MOTOR CAN CORD 5,5MM ROUND	439	1
29	70.0005.0	MOTORCANCMP BLACK C6 MAL2	424	1
30	70.0168.00	CARTRIDGE FILTER C06 BLACK	403	1
31	22.0094.86	PAPER BAG S/F NILFISK UZ934	301	1
32	04.0048.0	NUT M5 NYLON	179	2
33	73.0005.0	SCREW PT WN1412KB60X25 COMP.	331	2
34	S.76.9002.0	CLIP NYLON ASSY	S389	1
35	25.0033.0	SCREW COUNTERSUNK M5 X 12	406	2
36	77.0017.8	PAPER BAG HOLDER YELLOW FOR UZ934	330	1
37	77.0021.0	STORAGE CLIP LEFT C06/9 BLACK	439	1
38	77.0011.0	CAN CONNECT. COMPAC BLACK C9/6	327	1
39	25.0020.0	SOCKETS DOUBLE CASTOR	443	2
40	76.0012.0	CASTOR DOUBLE 50MM RUBBER/B/NY	322	2
41	78.0008.1	SHIMRING Ø 26 C9/6	430	2
42	77.0007.0	REARCASTOR GR. NON MARKING C9/6	426	2
43	77.0008.0	REARCASTOR BEARING BLACK C9/6	427	2
44	P.70.0015.S3	CAN ASSEMBLY C06 GREY	S498	1
45	70.0016.8	INSERT DUPRO YELLOW	329	1
46	03.0028.15	CABLE EUR 2P/1-RED-15MTR-A.C.	175	1
47	02.0032.5	CREVICE TOOL 32MM	174	1

## FREQUENTLY USED PARTS

NO.	ART CODE	DESCRIPTION	REF.	QTY.
1	K.10.22.0094.83	KIT PAPER BAG S/F NILFISK UZ934 [10 PIECES]	301	10
2	K.100.22.0094.83	KIT PAPER BAG S/F NILFISK UZ934 [100PIECES]	301	100
3	K.1.02.0032.5	KIT CREVICE TOOL 32MM [1 PIECE]	174	1
4	K.1.S.02.0040.5/1	KIT PLUMEAU ROUND 32MM NATURAL HAIR + BRITAL [1 PIECE]	185	1
5	K.1.02.0001.8S10/0	KIT TELESCOPIC WAND 32MM 630MM S/S BLCAK KNOB [1 PIECE]	104	1
6	K.1.77.0012.0	KIT FILTER CASSETTE C06/9 BLACK [1 PIECE]	S495	1
7	K.1.70.0168.00	KIT CARTRIDGE FILTER C06 BLACK [1 PIECE]	403	1
8	K.1.21.6342.302	KIT MOTOR D1 850W 230V VPD AMETEK [1 PIECE]	S394	1

